

FINAL BACKFILL
INITIAL BACKFILL
HS180 ENDCAP
UNDISTURBED SOIL
6" (150 mm) MIN

SEE DETAIL A
"THERMOPLASTIC LINER DETAIL"

1 LAYER OF NON-WOVEN
GEOTEXTILE (WHERE
REQUIRED BY ENGINEER)

HYDROSTOR
HS180 CHAMBER

PAVEMENT (PER
ENGINEER'S DRAWINGS)

SEE DETAIL A
"THERMOPLASTIC LINER DETAIL"

9" (230 mm) MIN
FOUNDATION THICKNESS
TO BE DETERMINED BY
THE DESIGN ENGINEER

23.5" (590 mm) MIN
8' (2.44 m) MAX

EMBEDMENT BACKFILL

EXCAVATION WALL
(SLOPED OR VERTICAL)

FOUNDATION STONE

SUITABLE SUBGRADE

ONE LAYER OF 6 oz/yd² (203 g/m²) NON-WOVEN GEOTEXTILE
ABOVE EMBEDMENT BACKFILL

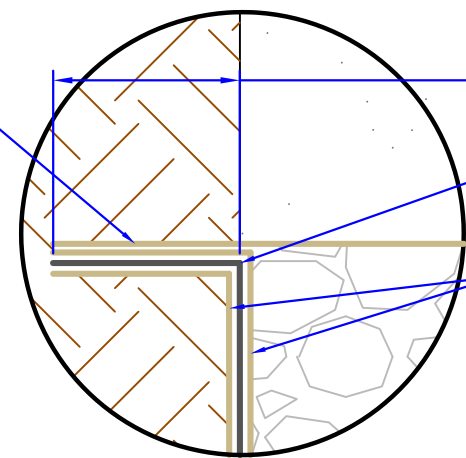

12" (300 mm) MIN OVERLAP TO
SECURE THERMOPLASTIC LINER

THERMOPLASTIC LINER¹

GEOTEXTILE ON EACH SIDE OF
THE THERMOPLASTIC LINER
(USED ON ALL THERMOPLASTIC
LINERS APPLIED)²

NOTES:

1. REFERENCE "HYDROSTOR HS180 - CROSS SECTION (D-7-200)" FOR ALL ACCEPTABLE FILL MATERIAL

¹THERMOPLASTIC LINER ON BOTTOM AND SIDES OF SYSTEM ONLY

¹THERMOPLASTIC LINERS OPTIONS INCLUDE:

- POLYVINYL CHLORIDE (PVC), 30 MIL (0.75 mm) PVC
- LINEAR LOW DENSITY POLYETHYLENE (LLDPE), 30 MIL (0.75 mm) LLDPE
- REINFORCED POLYPROPYLENE (RPP), EPDM, AND XR-5

² 6 oz/yd² (203 g/m²) NON-WOVEN GEOTEXTILE SHALL BE PLACED ON BOTH SIDES OF THERMOPLASTIC TO PROTECT AGAINST ANGULAR AGGREGATE ON THE WATER SIDE AND FROM PROTRUSION ON THE SOIL SIDE AT ANY LOCATION IN THE SYSTEM (SEE THERMOPLASTIC LINER DETAIL)

**DETAIL A
THERMOPLASTIC LINER DETAIL**

THIS DETAIL DEPICTS RECOMMENDED INSTALLATION PRACTICES AND IS NOT INTENDED TO SUPERSEDE ANY NATIONAL, STATE OR LOCAL SPECIFICATIONS. PRINSCO BEARS NO RESPONSIBILITY FOR ANY ALTERATIONS, REVISION AND/OR DEVIATION FROM THIS STANDARD DETAIL. PRINSCO HAS NOT PERFORMED ANY ENGINEERING OR DESIGN SERVICE FOR THIS PROJECT. THE DESIGN ENGINEER SHALL REVIEW THESE DETAILS PRIOR TO CONSTRUCTION TO VERIFY SUITABILITY. © PRINSCO, INC.



1717 16TH ST. NE
WILLMAR, MN 56201
www.prinsco.com

TITLE: HYDROSTOR HS180 - CROSS SECTION DETENTION		REV:
DRAWN BY: TRA	DATE: 11-Oct-18	DRAWING NUMBER:
SCALE: NTS	SHEET: 1 OF 1	D-7-200B