

### Overview

This guide provides direction for proper installation of Prinsco’s Tap Tee. This will ensure simplicity in the installation process, while providing a quality connection to the main line.

### Product Selection

Use the following table to determine which tap tee type and hole saw diameter is needed for the given mainline pipe size.

**Table 1: Tap Tee-Mainline Configuration Recommendations**

Size	Part #	Type	Hole Saw Dia.	Mainline Pipe Size
4"	TT04S	Short	4"	*6"-8"
4"	TT04L	Long	4"	10"-15"
5"	TT05S	Short	5"	8"-12"
5"	TT05L	Long	5"	15"-18"
6"	TT06S	Short	6"	15"-24"
6"	TT06L	Long	6"	30"-36"

\*Special care must be taken to ensure backfill completely surrounds and is compacted around connection

### Installation

Step 1: When digging a “starter hole” down to the mainline pipe, it is best to preserve as much soil support around the pipe as possible. As conditions allow, only excavate to the area where the hole will be cored.

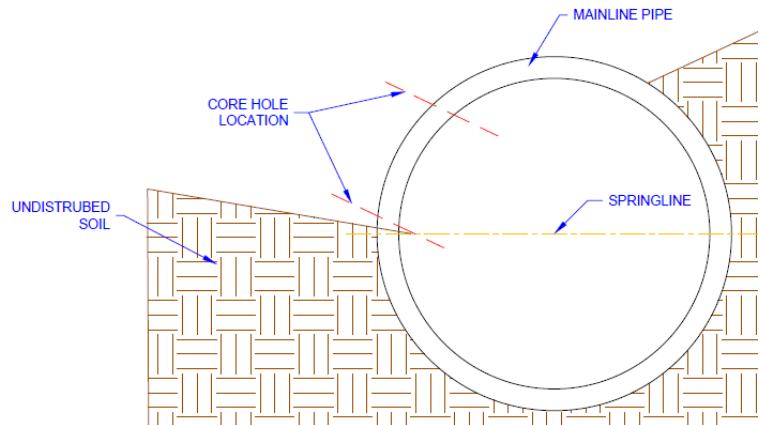

**Figure 1: Excavation and Cored Hole Location**

Step 2: Using a hole saw matching the tap tee diameter (4” hole saw for 4” lateral connection), drill a hole into the main pipe, centered on the top of a corrugation, preferably above the springline.

Step 3: Pinch the tap tee at the high points on the curved end.

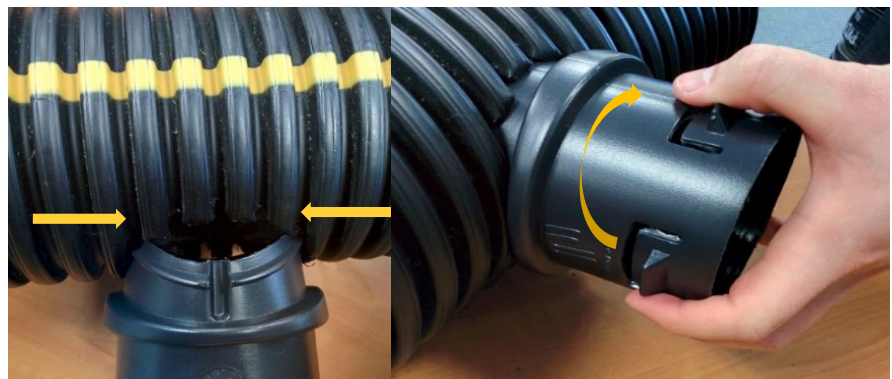

**Figure 2: Tap Tee Installation**

Step 4: Insert the tee into the pipe with the points first. Rotate the tap tee to ensure the curve of the lugs match the ID of the mainline pipe



Step 5: Attach lateral pipe and blind the connection. When possible, use dry granular material when blinding/backfilling. This allows the backfill to fill in the voids around the connection. Backfill should also be compacted around the pipe to provide support to both the lateral and mainline which is critical for the structural longevity of the connection. Make sure the lateral pipe sits on undisturbed or compacted native soil to maintain grade and pipe support.

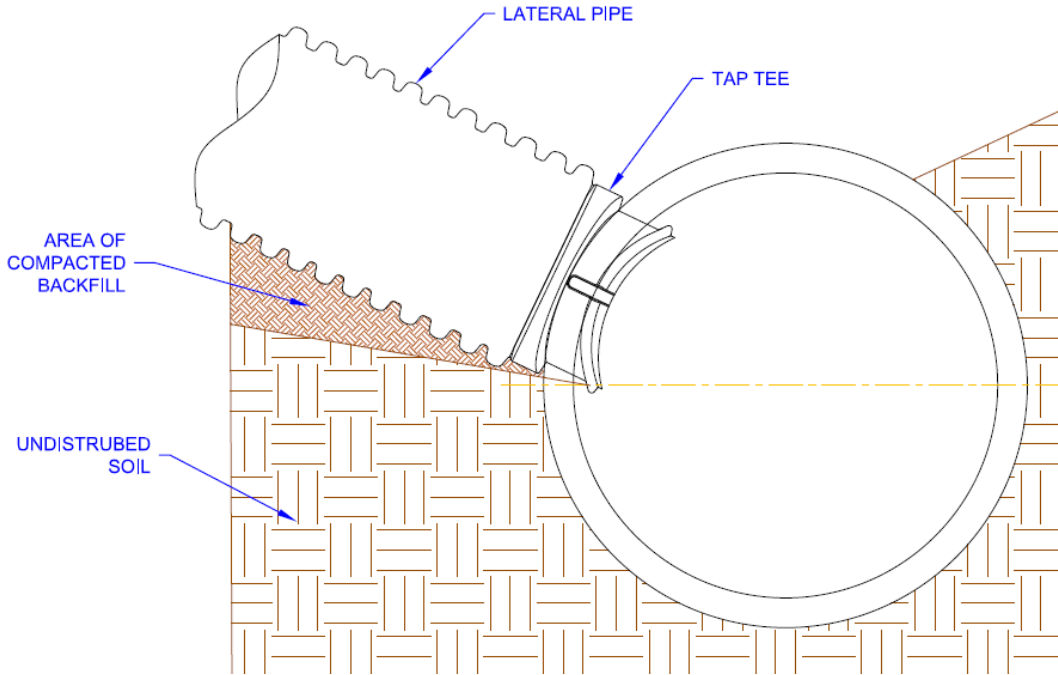

Figure 3: Installed Tap Tee and Lateral with Proper Pipe Support